

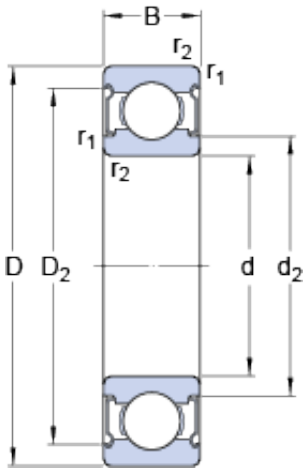

NUP BEARING LTD

7 mm x 26 mm x 9 mm skf W 637-2Z Deep groove ball bearings

Bearing No. W 637-2Z



W 637-2Z Bearing 2D drawings and 3D CAD models

Size	26x7x9 mm
Bore Diameter	26 mm
Outer Diameter	7 mm
Width	9 mm
d	7 mm
D	26 mm
B	9 mm
d ₂	13.9 mm
D ₂	22.38 mm
r _{1,2} - min.	0.3 mm
d _a - min.	9 mm
d _a - max.	13.8 mm
D _a - max.	24 mm
r _a - max.	0.3 mm
Basic dynamic load rating - C	4 kN
Basic static load rating - C ₀	2 kN
Fatigue load limit - P _u	0.083 kN
Reference speed	67000 r/min
Limiting speed	32000 r/min
Calculation factor - k _r	0.035
Calculation factor - f ₀	12.4
d ₂	13.9 mm
D ₂	22.38 mm
r _{1,2} min.	0.3 mm



NUP BEARING LTD

d_a min.	9 mm
d_a max.	13.8 mm
D_a max.	24 mm
r_a max.	0.3 mm
Basic dynamic load rating C	3.97 kN
Basic static load rating C_0	1.96 kN
Fatigue load limit P_u	0.083 kN
Calculation factor k_r	0.035
Calculation factor f_0	12.4
Mass bearing	0.024 kg