

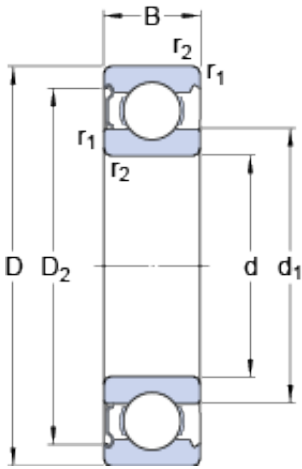

# NUP BEARING LTD



4 mm x 16 mm x 5 mm skf 634-Z Deep groove ball bearings

Bearing No. 634-Z

634-Z Bearing 2D drawings and 3D CAD models

Size	16x4x5 mm
Bore Diameter	16 mm
Outer Diameter	4 mm
Width	5 mm
d	4 mm
D	16 mm
B	5 mm
d <sub>1</sub>	8.4 mm
D <sub>2</sub>	13.3 mm
r <sub>1,2</sub> - min.	0.3 mm
d <sub>a</sub> - min.	6.4 mm
d <sub>a</sub> - max.	8.3 mm
D <sub>a</sub> - max.	13.6 mm
r <sub>a</sub> - max.	0.3 mm
Basic dynamic load rating - C	1.1 kN
Basic static load rating - C <sub>0</sub>	0.38 kN
Fatigue load limit - P <sub>u</sub>	0.016 kN
Reference speed	95000 r/min
Limiting speed	60000 r/min
Calculation factor - k <sub>r</sub>	0.03
Calculation factor - f <sub>0</sub>	8.4
Size	16x4x5 mm
Bore Diameter	16 mm
Outer Diameter	4 mm



## NUP BEARING LTD

Width	5 mm
d	4 mm
D	16 mm
B	5 mm
d <sub>1</sub>	8.4 mm
D <sub>2</sub>	13.3 mm
r <sub>1,2</sub> - min.	0.3 mm
d <sub>a</sub> - min.	6.4 mm
d <sub>a</sub> - max.	8.3 mm
D <sub>a</sub> - max.	13.6 mm
r <sub>a</sub> - max.	0.3 mm
Basic dynamic load rating - C	1.1 kN
Basic static load rating - C <sub>0</sub>	0.38 kN
Fatigue load limit - P <sub>u</sub>	0.016 kN
Reference speed	95000 r/min
Limiting speed	60000 r/min
Calculation factor - k <sub>r</sub>	0.03
Calculation factor - f <sub>0</sub>	8.4
d <sub>1</sub>	8.4 mm
D <sub>2</sub>	13.3 mm
r <sub>1,2</sub> min.	0.3 mm
d <sub>a</sub> min.	6.4 mm
d <sub>a</sub> max.	8.3 mm
D <sub>a</sub> max.	13.6 mm
r <sub>a</sub> max.	0.3 mm
Basic dynamic load rating C	1.11 kN
Basic static load rating C <sub>0</sub>	0.38 kN
Fatigue load limit P <sub>u</sub>	0.016 kN
Calculation factor k <sub>r</sub>	0.03
Calculation factor f <sub>0</sub>	8.4
Mass bearing	0.0054 kg



# NUP BEARING LTD